

# Elbow, Cap, Bend

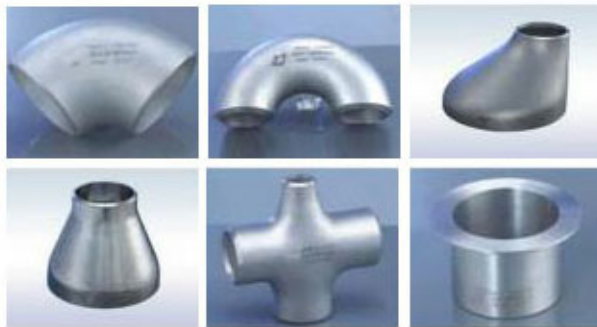

## Welding Fittings

## ANSI B 16.9



90° Long Radius Elbow



90° Reducing Long Radius Elbow



Cap



90° Short Radius Elbow



45° Long Radius Elbow



180° Extra Long Radius Return



180° Short Radius Return

# Stub Bend

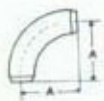

90° Extra Long Radius Elbow

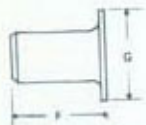

Lap Joint Stub End



180° Long Radius Return



45° Extra Long Radius Elbow

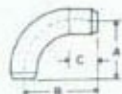

90° Long Radius Elbow with Long Tangent one End

## Carbon/Alloy Steel Seamless Pipes

### Dimensions IS to ANSI B 36.10



SIZE	1/4" NB TO 24" NB IN Sch 40,60,80,120,160 & XXS. (Carbon steel)
Carbon Steel: Specifications	ASTM A 53, A 106, A 179, API 5L/5LX, BSS, 3059, 182, 806, 3601, 3602, DIN 17175. 2448 etc.

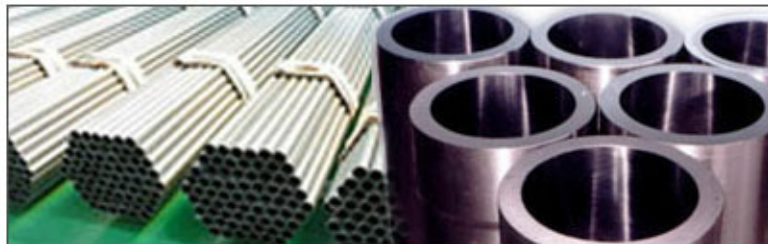

# Elbow, Cap, Bend

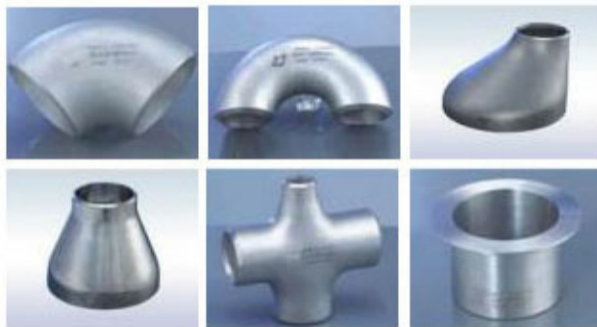

## Welding Fittings

## ANSI B16.9



90° Long Radius Elbow



90° Reducing Long Radius Elbow



Cap



90° Short Radius Elbow



45° Long Radius Elbow



180° Extra Long Radius Return



180° Short Radius Return

# Tee

Conversion Table  
Inch/Millimeter

ANSI B 16.9

Straight and  
Reducing Outlet  
Tees  
Crosses

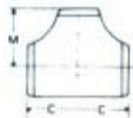

Tees



Crosses



**STRAIGHT AND REDUCING OUTLET TEES CROSSES**

# Reducer

CONCENTRIC



Concentric



Eccentric

ECCENTRIC



# Elbow, Cap, Bend

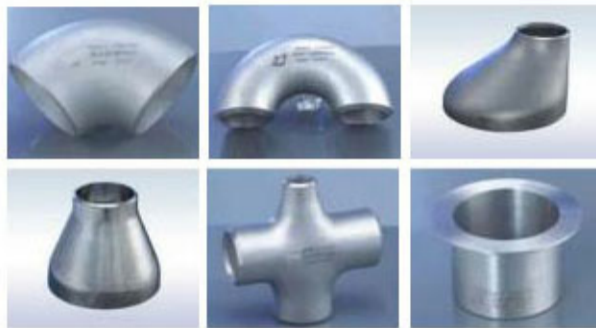

## Welding Fittings

## ANSI B 16.9



90° Long Radius Elbow



90° Reducing Long Radius Elbow



Cap



90° Short Radius Elbow



45° Long Radius Elbow



180° Extra Long Radius Return



180° Short Radius Return